

# Duet™

## Variable Dispense Applicators

### Optimize adhesive use for high performance elastic attachment

#### Benefits:

- Produce high-quality, high-performance elastic features
- Optimize adhesive usage
- Reduce maintenance time and cost of ownership
- Maximize production efficiency

The patented Nordson Duet dual-module applicators deliver different add-on rates at the ends of the elastic strands than in the center. The heavier adhesive add-on at the ends yields high bond strength while the lighter add-on in the center provides a stabilizing bond. The optimized stabilizing bond in the center retains the retractive force of the elastic strand while reducing adhesive use.

The Duet applicator's narrow profile and small footprint facilitate installation in tight production spaces. And, the pair of Duet applicators – one operator side and one drive side – when used together provides for application flexibility during product changeover. The patented Universal™ nozzle clamping mechanism allows easy changing of the Allegro® and SureWrap® nozzles that promote optimized coating of elastic strands.

The high-speed, long-life Nordson Speed-Coat® modules accurately and reliably dispense hot melt adhesive to support demanding, high-speed production. And, retract-on-close module operation delivers exceptional cutoff.

Quick-change heaters, sensors, filters and modules improve serviceability, simplify maintenance and minimize production downtime. And, the rebuildable Speed-Coat modules help reduce maintenance costs and improve service life.

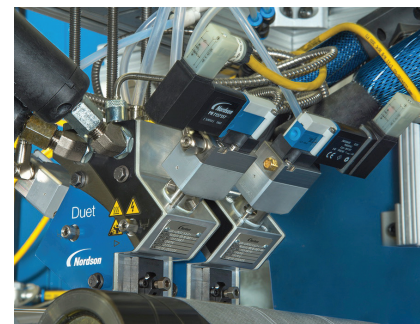
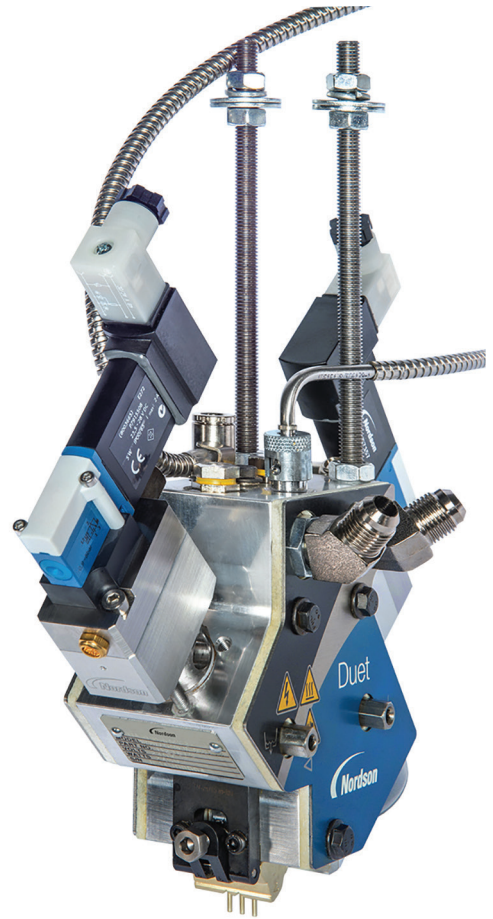

*Modules can be rotated 90° from vertical to allow installation flexibility.*

**Specifications**

Nozzle Compatibility	Allegro® & SureWrap® nozzles
Operating Temperature	70 <sup>o</sup> to 205 <sup>o</sup> C (160 <sup>o</sup> to 400 <sup>o</sup> F)
Working Hydraulic Pressure	13.8 to 55.2 bar (200 to 800 psi)
Maximum Hydraulic Pressure	89.6 bar (1300 psi)
Maximum Hydraulic Flow (per module)	110 grams per minute at 10,000 centipoise, 14 grams per square meter at 300 m/min.
Actuation Air Pressure <sup>1</sup>	5 to 6 bar (73 to 88 psi) recommended
Cycle Rate <sup>2</sup>	Up to 9000 cycles per minute or 6 milliseconds for on/off cycle
Maximum Process Air Flow	1.5 scfm
Solenoid Voltage	23.5 to 28 VDC
Solenoid Power Consumption	5 watts
Solenoid Connection	Quick-disconnect with strain relief and LED indicator
Solenoid Air Consumption	21 liter/min (0.75 cubic feet/min) @ 3000 cycles/min 63 liters/min (2.25 cubic feet/min) @ 9000 cycles/min

<sup>1</sup>Oil-free air must be used.

<sup>2</sup>Maximum number of cycles depends on operating and control air pressures, and adhesive viscosity.

**Dimensions - in. / (mm)**

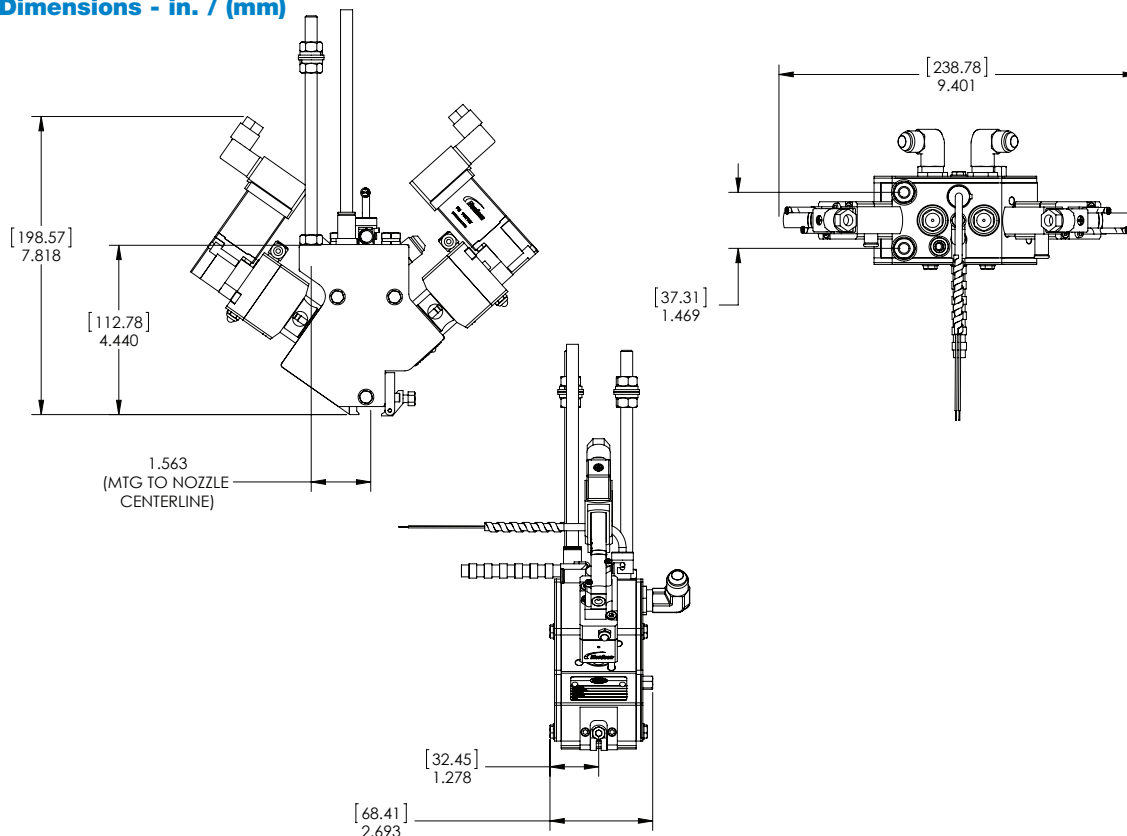

For more information, speak with your Nordson representative or contact your Nordson regional office.

**United States**

Duluth, Georgia  
(800) 683-2314 Phone  
(866) 667-3329 Fax

**Europe**

Luneburg, Germany  
(49) 4131-894-0 Phone  
(49) 4131-894-149 Fax

**Japan**

Tokyo, Japan  
(81) 3-5762-2700 Phone  
(81) 3-5762-2701 Fax

**Asia/Australia/  
Latin America**

Amherst, Ohio  
(440) 985-4496 Phone  
(440) 985-1096 Fax

Find us on:



NWL-14-5879  
Issued 12/14  
© 2014 Nordson Corporation  
All Rights Reserved.  
Printed in U.S.A.  
Nordson reserves the right to make design changes between printings.